

installation guide



# BR

Flexible Reinforced  
Noise Barrier

meegasorber®

# BR

These recommendations are for general guidance only. Installation methods must be tested under actual service conditions to determine their suitability for a particular purpose.



**1**  
Cutting (if required)  
Product supplied in 1.35m x 5m rolls. This product can be cut by hand using a sharp utility knife.



**2**  
Clean substrate surface with Megasorber AC5, acetone or similar. The surface must be dry, free of oil, dust, grease, rust and other contaminants.



**3**  
Install the product direct fix onto existing walls, or onto timber studs for new builds.

## New builds - Direct fix onto timber studs

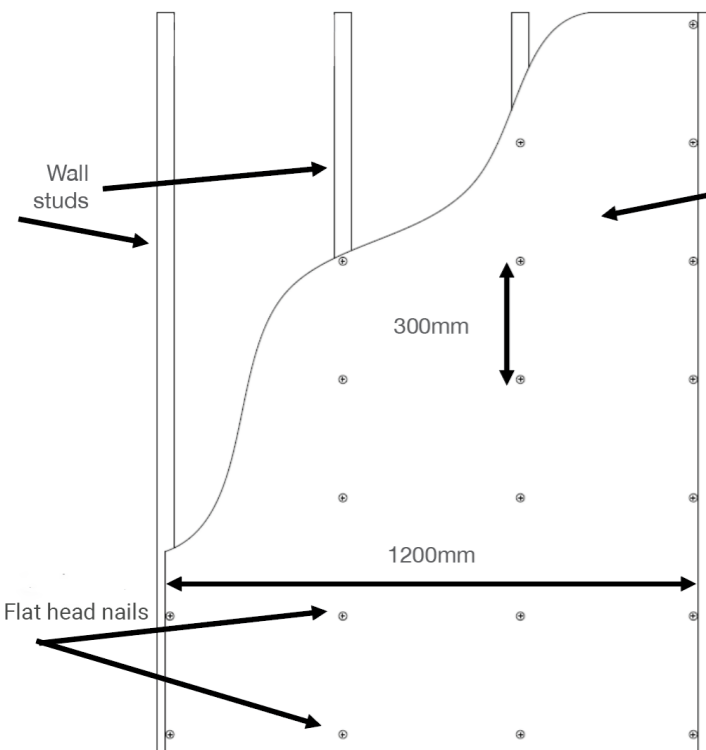

Megasorber BR

Adhere to wall studs using flat head nails every 300mm from left-to-right and top-to-bottom.

## installation guide

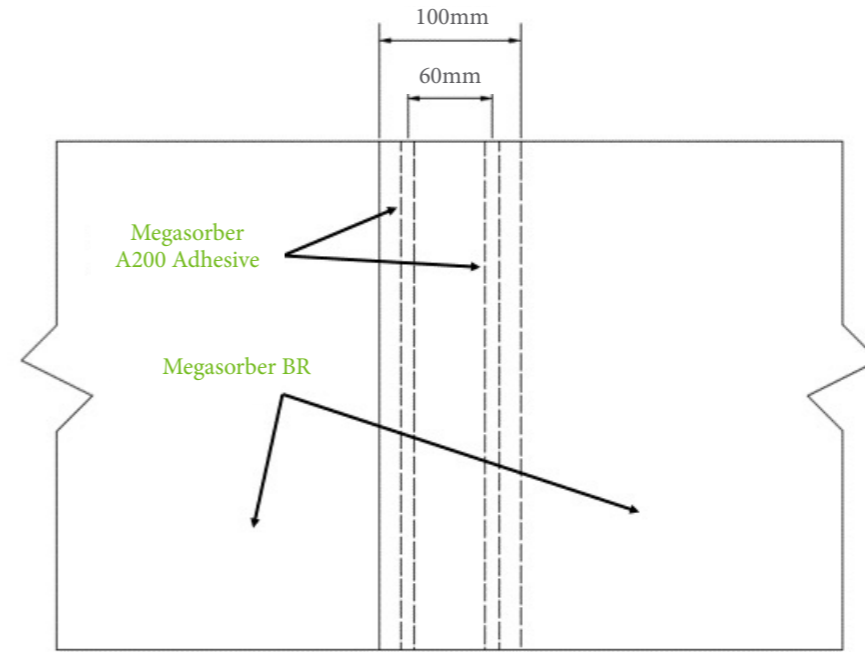

Overlap sheets (if required)

When the edges of the sheets do not meet at studs, the common edge should be overlapped and sealed using Megasorber A200SG adhesive.

The A200 should be applied approx. 20mm from the edge of each sheet and each bead should be approx. 10mm thick.

## Existing walls - Direct fix to plasterboard or hang like a curtain by making eyelids in the BR

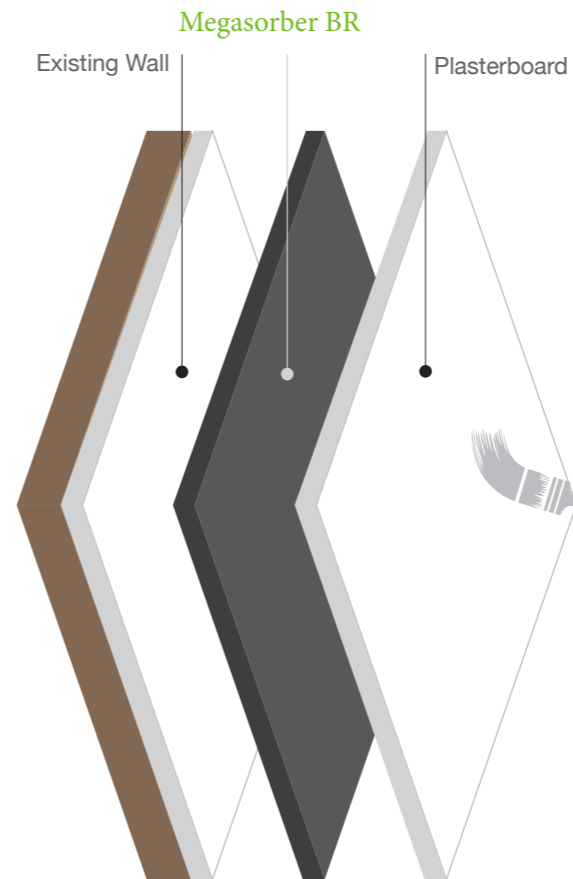

Apply Megasorber A200 with a battery-powered caulking gun.

Example cut panel size 1.35m x 2.7m adhesive application:

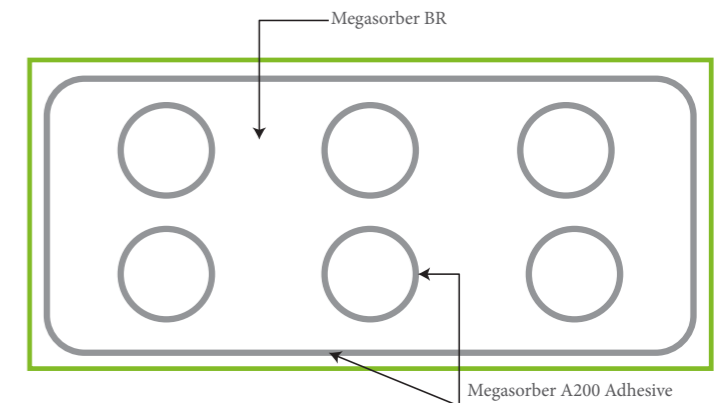

Minimum bead size (glue width) = 10mm to 15mm diameter.  
Recommended usage: approx. 1.5 to 2 sausages per cut size panel (1.35 x 2.7m), or approx. 3-4 cartridges per full size panel.

The wall is ready for the final sheet of plasterboard to be installed.

Important Note: adhesive other than Megasorber A200 must be tested for suitability and compatibility. Product may react with other contact adhesives.